

CAPITAL TOOL INDUSTRIES

Code
Desig. Num.

INTERNAL GEAR'S SPECIFICATION	
PART NUM.	
TOOTH PROFILE	
OPERATION	
MODULE / D.P.	Mn 1
PRESSURE ANGLE	α 30°
NUM. OF TEETH	z1 42
HELIX ANGLE	β
MAJOR DIAMETER	dk1 43.63
PITCH DIAMETER	do1 42
MINOR DIAMETER	df1 41.132
WHOLE DEPTH. (D+f)	h
ADDENDUM MODIF.	xma
TOOTH THICKNESS	Sn
MEASUREMENT OVER PINS	Mr
OVER PINS Ø SHAPED	Mr' 39.5665
PIN DIAMETER	dr 1.750
SPAN MEASUREMENT F	Wn
SPAN MEASUREMENT H.	Wn'
NUM. OF TEETH SPANNED	zn
FINISHING STOCK FLANC	Cn
CHAMFER AFTER FINISH.	q1
TIP MODIFICATION	
ACTIVE DIAMETER	dof
SAP (Start active profile)	

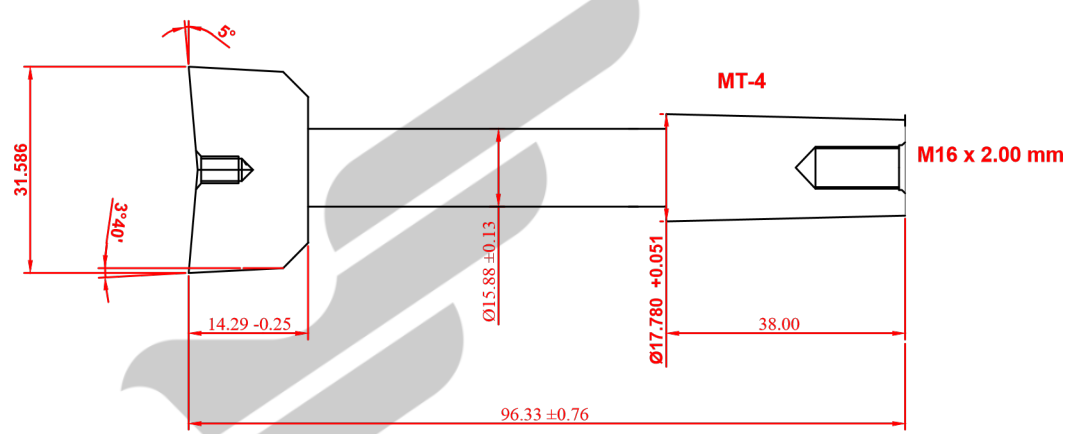

D+F =
Modif = 0

Własność intelektualna firmy:
Tradensa Sp. z o. o.
 Ul. Urocza 5a, 62-081 Wysogotowo
 NIP: 781-20-22-828
 KRS: 0000910290

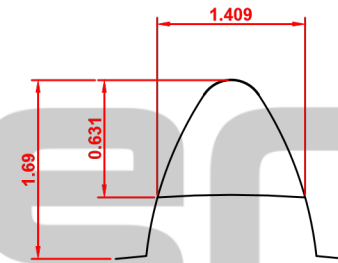

SHAPER SPECIFICATION	
SIDE CLEARANCE R. FLANK	2.1666°
SIDE CLEARANCE L. FLANK	2.1666°
PITCH DIAMETER	do1 30
NUM. OF TEETH	i 30
HELIX ANGLE	β 0°
MODULE / D.P.	Mn 1
PRESSURE ANGLE	α 30°
CLASS	A
KEYWAY	NO
MATERIAL OF SHAPER	G50
SHAPER SIZE	
RAKE ANGLE	ϵ
CAM	hr
CLEARANCE ANGLE	$\phi\kappa/\phi$
MARKING:	1 MOD 30°PA 30 T D+F 1.2627 G50 FLAT ROOT FA 5° ID-44204-001-1.00
DESIGN	APPROVED
DATE :	DATE :
CHARGE:	APPROVED:

SHANK SHAPER

ALL UNITS ARE IN MILLIMETERS



Customer	A	DESIGN EDITION		